

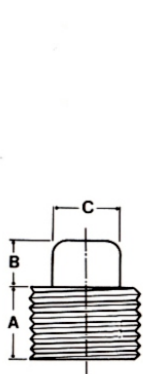

## Raccordi filettati - Threaded fittings



**Tappi T. quadra**  
Square H. plugs



**Tappi T. esag.**  
Hex. H. plugs

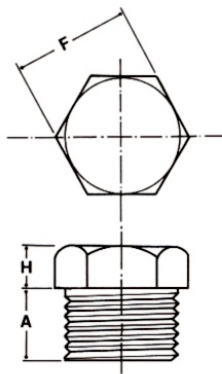

**Tappi T. tonda**  
Round H. plugs

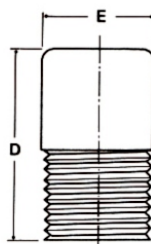

**Riduz. esag. M/F**  
Bushings

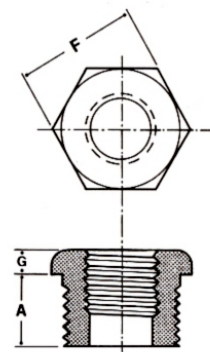

| O NOMINALE<br>PIPE SIZE | 1/8  | 1/4  | 3/8  | 1/2  | 3/4  | 1    | 1 1/4 | 1 1/2 | 2    | 2 1/2 | 3    | 4     |
|-------------------------|------|------|------|------|------|------|-------|-------|------|-------|------|-------|
| A MIN.                  | 9.5  | 11.0 | 12.5 | 14.5 | 16.0 | 19.0 | 20.5  | 20.5  | 22.0 | 27.0  | 28.5 | 32.0  |
| B MIN                   | 6    | 6    | 8    | 10   | 11   | 13   | 14    | 16    | 17   | 19    | 21   | 25    |
| C MIN                   | 7.0  | 9.5  | 11.0 | 14.5 | 16.0 | 20.5 | 24.0  | 28.5  | 33.5 | 38.0  | 43.0 | 63.5  |
| D MIN                   | 35   | 41   | 41   | 44   | 44   | 51   | 51    | 51    | 64   | 70    | 70   | 76    |
| E NOM                   | 10   | 13   | 17   | 21   | 27   | 33   | 43    | 48    | 60   | 73    | 89   | 114   |
| F NOM                   | 11.0 | 16.0 | 17.5 | 22.0 | 27.0 | 35.0 | 44.5  | 51.0  | 63.5 | 76.0  | 89.0 | 117.5 |
| G MIN                   | -    | 3    | 4    | 5    | 6    | 6    | 7     | 8     | 9    | 10    | 10   | 13    |
| H MIN                   | 6    | 6    | 8    | 8    | 10   | 10   | 14    | 16    | 17   | 19    | 21   | 25    |

